

LOCATOR® BAR ATTACHMENT SYSTEM

CAST-TO BAR

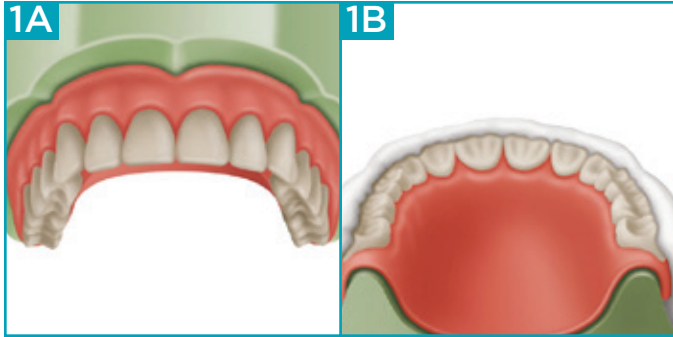

1A-1B After completing the overdenture wax try-in, make a matrix of the teeth set up.

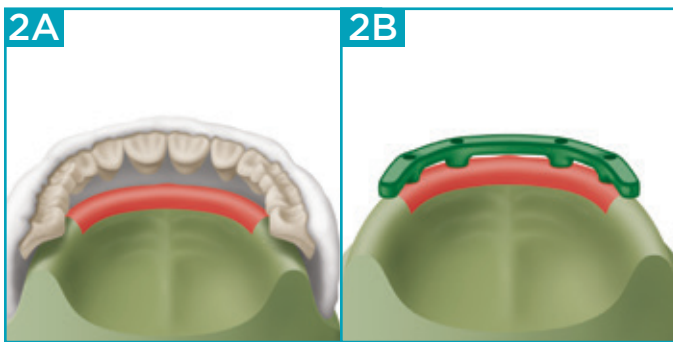

2A-2B With the teeth placed back in the matrix, seat the matrix on the model. Determine the locations for the LOCATOR Bar Abutments in relation to the implant positions, spacing between attachments and the interarch space. Wax the overdenture bar to the implant components.

A minimum of 5.0mm between the edges of multiple LOCATOR Bar Abutments is required to avoid interference with the Denture Caps.

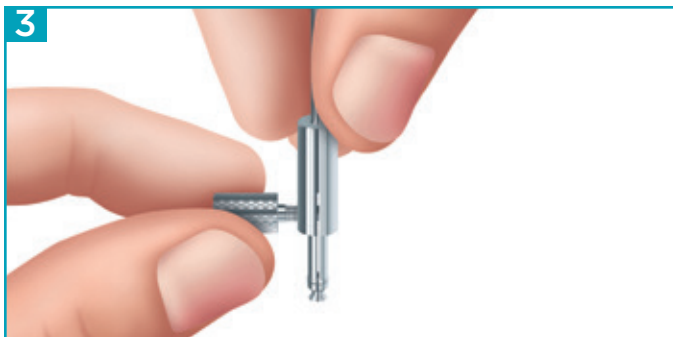

3 Place the split end of the LOCATOR Paralleling Mandrel into the socket of the Laser Bar Abutments and finger tighten the knurled set screw to spread the split portion and secure the Abutments on the mandrel.

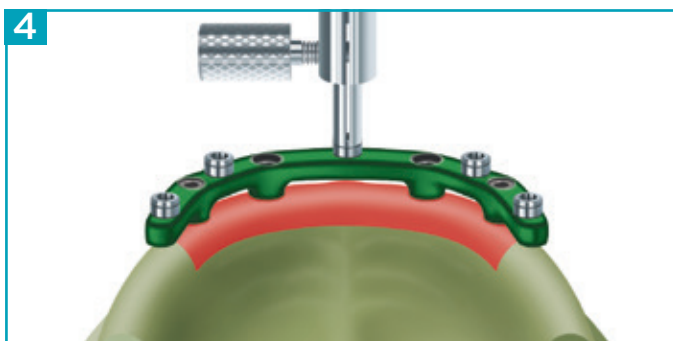

4 Use the LOCATOR Paralleling Mandrel in a surveyor to place all the Cast-To Bar Abutments into the waxed bar ensuring parallelism. Wax the Cast-To Bar Abutments into position.

LOCATOR® BAR ATTACHMENT SYSTEM

CAST-TO BAR (CONTINUED)

5

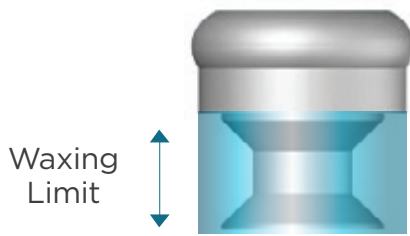

5 Wax should be built up to the top of the retentive recess and not above the line indicated.

6

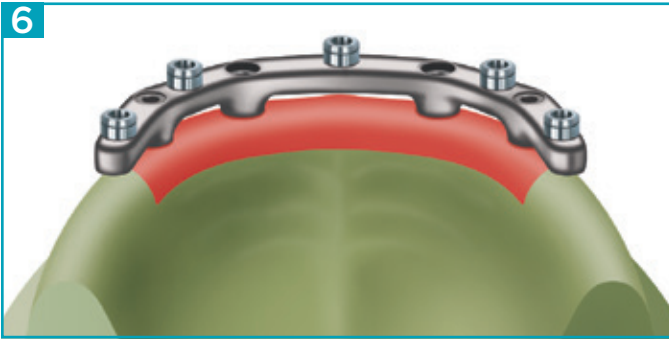

6 Invest and cast the Bar using standard casting procedures. The Cast-To Bar Abutments will become part of the cast bar.

7

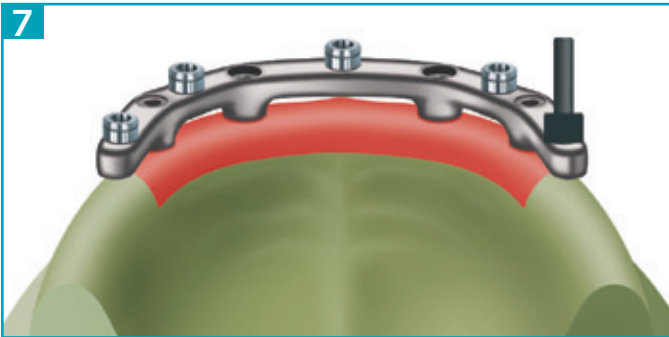

7 Divest, finish and polish the cast bar. Use caution to not damage the Cast-To Abutments. A LOCATOR Parallel Post may be placed on the Abutment to protect it while polishing.

8

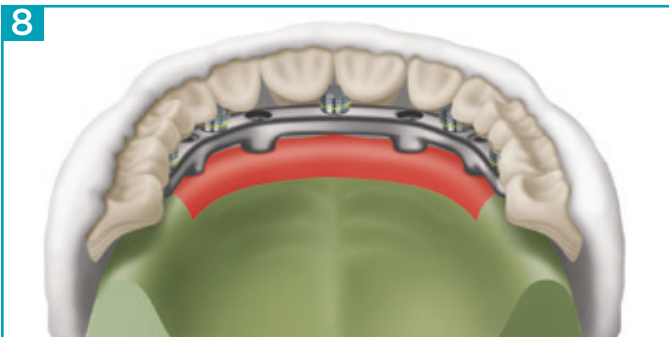

8 Snap a Denture Cap with a Yellow Processing Male onto each LOCATOR Abutment and verify that there are no interferences with the bar.

Proceed with the fabrication of the prosthesis.